

PSM303820A51

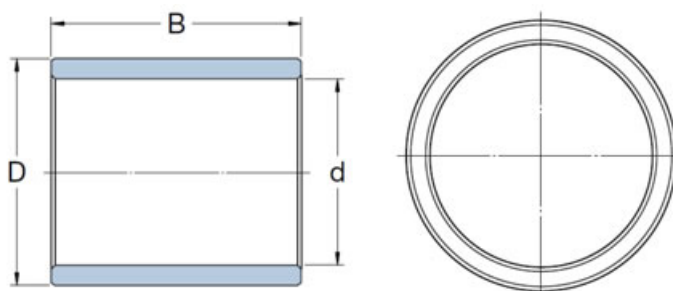

Technical sheet of PSM303820A51

Type :	Sleeve Bearing	
Model :	PSM303820A51	
Main demensions :	30 mm × 38 mm × 20 mm	Bore Dia × Outside Dia × Width Dia
M kg:	0.053	Mass
d mm:	30	inner ring diameter
D mm:	38	Outer ring diameter
B(T) mm:	20	Overall Width

Detailed parameters and installation dimensions:

Part Number: PSM303820A51

Technical description (A51): A51=(SINT A51) Sintered Bronze Bushing With A Porosity Volume Of 28% Impregnated With Mineral Oil.

The equivalent designations: 7316571790824

Bearing Type: Bushing

Size(metric): Inner dia. (d): 30 mm X Outer dia. (D): 38 mm X Width (B): 20 mm or Size: 30 mm * 38 mm * 20 mm

Original Equipment Manufacture(OEM NO.): PSM303820A51

Tradebearing(TBS): <https://en.tradebearings.com/>

Email: admin@tradebearings.com

Whatsapp/Mob.: +86 15906428604