

## 22215.EAKW33C3

spherical roller bearings tapered bore

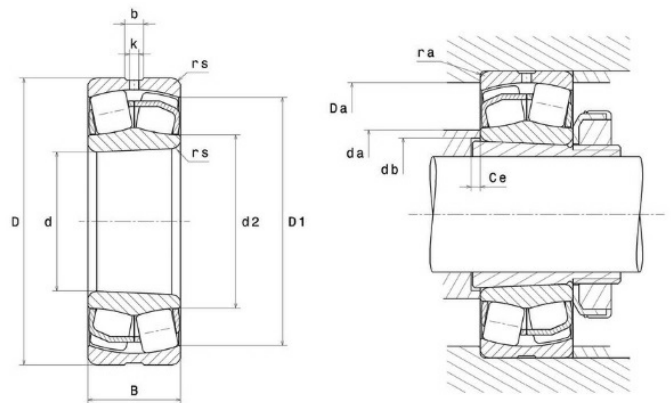

### Technical sheet of 22215.EAKW33C3

#### What are the Benefits of choosing 22215.EAKW33C3 bearings?

- **Self-aligning:** Allows for significant angular errors or shaft deflection between the shaft and bearing housing, effectively compensating for installation errors and shaft deformation.
- **High load capacity:** Featuring a double-row roller structure, it boasts extremely high radial load capacity while also withstanding certain bidirectional axial loads.
- **Adaptable to vibration applications:** Performs excellently under impact and vibration loads, exhibiting good durability.
- **Easy installation:** Models with tapered bores are typically available, allowing for convenient installation at any position on different optical shafts using adapter sleeves or withdrawal sleeves.

Type :	Spherical Roller Bearings	
Model :	<a href="https://en.tradebearings.com/22215.EAKW33C3">22215.EAKW33C3</a>	
Main demensions :	75 mm × 130 mm × 31 mm	Bore Dia × Outside Dia × Width Dia
M kg:	1.56	Mass
HS Code :	8482300000	Bearing customs code
d mm:	75	inner ring diameter
D mm:	130	Outer ring diameter
B(T) mm:	31	Overall Width

<b>Cr kN:</b>	243.28	Radial dynamic load rating
<b>C<sub>0r</sub> kN:</b>	247.91	Radial static load rating
<b>Grease r/min:</b>	4589	Reference speed
<b>Oil r/min:</b>	6181	Limiting speed

#### Detailed parameters and installation dimensions:

Part Number	22215.EAKW33C3
Design type	E = Increased capacity design, symmetrical rollers
Dynamic Radial Capacity - C <sub>r</sub>	243280 N   54689 lbf
Static Radial Capacity - C <sub>0r</sub>	247910 N   55730 lbf
Temperature - T(min)	-40 °C
Temperature - T(max)	200 °C
Internal clearance	C3
Cage	A = Two steel plate cages with window centred on the inner ring
Dimension fillet radius - r <sub>s</sub>	1.5 mm   0.059 inch
Dimension - r <sub>a</sub> (max.)	1.5 mm   0.059 inch
Series	222 (222..EAKW33)
Principal Dimensions Inside - d φ	75 mm   2.953 inch
Principal Dimensions Outside - D Φ	130 mm   5.118 inch
Principal Dimensions Width - B	31 mm   1.220 inch
Load	radial
Units	Metric
Groove width - b	7.37 mm   0.290 inch
Hole diameter - k	3.5 mm   0.138 inch
Bearing Mass - m	1.56 kg   3.439 lb
Cage Type	Pressed
bearing_type	spherical roller bearings tapered bore
Speed ratings (grease) - n <sub>B</sub>	4589 r/min
Speed ratings (oil) - n <sub>G</sub>	6181 r/min
Lubrication	W33 = Groove and lubrication holes on outer ring
Bore	K = Tapered bore (taper 1:12)
Fatigue load limit - C <sub>u</sub>	29711 N   6679 lbf
Dimension - d <sub>2</sub>	88.4 mm   3.480 inch
Dimension - D <sub>1</sub>	117.8 mm   4.638 inch
Ring Material	Hardened Steel
Roller Material	GCr15SiMn
Sleeve	H315
Factors - e	0.22
Factors - Y <sub>0</sub>	3.06
Manufacturer Part Code	22215.EAKW33C3
Abutment dimensions - d <sub>a</sub> (min.)	84 mm   3.307 inch

Factors - $Y_1$	3.13
Factors - $Y_2$	4.67
Precision level	Standard
Seal	Open
Abutment dimensions - $d_b$ (min.)	80 mm   3.150 inch
Abutment dimensions - $D_a$ (max.)	121 mm   4.764 inch
Abutment dimensions - $C_e$ (min.)	12 mm   0.472 inch
Row No.	double
Temperature - T(min)	-40 °F
Temperature - T(max)	400 °F
Number of lubrication holes	3

### What are the applications of the 22215.EAKW33C3 bearing?

- **Mining/Metallurgy/Cement:** Used in crushers and vibrating screens. Impact resistant, withstands extreme heavy loads, and adaptable to harsh environments.
- **Paper/Steel:** Used in rolling mills and roller conveyors. Automatic self-aligning compensation effectively addresses shaft deflection or misalignment.
- **Industrial Transmission:** Used in speed reducers and fans. Smooth operation, long service life, and withstands complex composite loads.

**Tradebearing(TBS):** <https://en.tradebearings.com/>

Email: [admin@tradebearings.com](mailto:admin@tradebearings.com)

Whatsapp/Mob.: +86 15906428604