

6203.Z

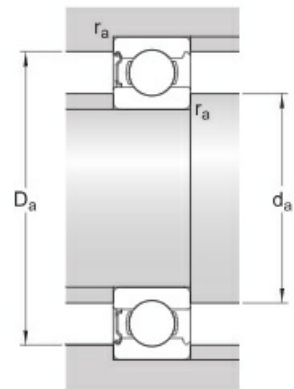
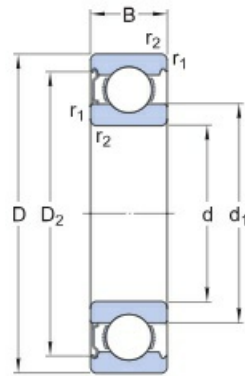

Technical sheet of 6203.Z

Type :	Single row deep groove ball bearings	
Model :	6203.Z	
Main demensions :	17 mm × 40 mm × 12 mm	Bore Dia × Outside Dia × Width Dia
M kg:	0.0634	Mass
HS Code :	8482102000	Bearing customs code
d mm:	17	inner ring diameter
D mm:	40	Outer ring diameter
B(T) mm:	12	Overall Width
Cr kN:	9.879	Radial dynamic load rating
C0r kN:	4.689	Radial static load rating
Grease r/min:	37985	Reference speed
Oil r/min:	23934	Limiting speed

Detailed parameters and installation dimensions:

Part Number	6203.Z
Cage	Stamped steel cage, ball centred
Rows NO.	One
Series	62..-Z

Principal Dimensions Inside - $d \phi$ (mm)	17
Principal Dimensions Outside - $D \Phi$ (mm)	40
Principal Dimensions Width - B (mm)	12
Minimum load coefficient - k_r	0.025
Calculation coefficient - f_0	13
Dynamic Radial Capacity - C_r	9879 N 2220 lbf
Static Radial Capacity - C_{0r}	4689 N 1054 lbf
Ring Material	GCr15SiMn
Dimension - d_1	24.5 mm 0.965 inch
Bore Type	Cylindrical bore
Seal	Z = Shield on one sides
Dimension - D_2	34.98 mm 1.377 inch
Speed ratings (grease) - n_B	37985 r/min
Lubricant	No
Dimension Chamfer - $r_{1,2}$ (min.)	0.6 mm 0.024 inch
Fillet dimensions - r_a (max.)	0.6 mm 0.024 inch
Speed ratings (oil) - n_G	23934 r/min
Fatigue load limit - P_u	198 N 44 lbf
Internal clearance	CN
Outer ring feature	No
Principal Dimensions Inside - $d \phi$ (inch)	0.669
Principal Dimensions Outside - $D \Phi$ (inch)	1.575
Principal Dimensions Width - B (inch)	0.472
Heat stabilized	120 °C (250 °F)
Ball Material	GCr15SiMn
Bearing type	Capped single row deep groove ball bearings
Bearing Mass - m	0.0634 kg 0.140 lb
Manufacturer Part Code	6203-Z
Abutment dimensions - d_a (min.)	21.2 mm 0.835 inch
Tolerance class	P6
Abutment dimensions - d_a (max.)	24.4 mm 0.961 inch
Abutment dimensions - D_a (max.)	35.8 mm 1.409 inch
Radial run-out	P5
Dimensional tolerances	P6

Tradebearing(TBS): <https://en.tradebearings.com/>

Email: admin@tradebearings.com

Whatsapp/Mob.: +86 15906428604