

22214

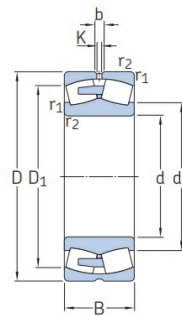

Cylindrical bore



Tapered bore

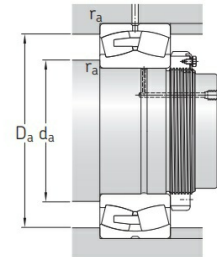

Type :	Spherical Roller Bearings	
Model :	22214	
Old Code :	3514	
Main demensions :	70 mm × 125 mm × 31 mm	Bore Dia × Outside Dia × Width Dia
M kg:	1.6	Mass
HS Code :	8482300000	Bearing customs code
d mm:	70	inner ring diameter
D mm:	125	Outer ring diameter
B(T) mm:	31	Overall Width
Cr kN:	212.809	Radial dynamic load rating
C0r kN:	227.926	Radial static load rating
Oil r/min:	6671	Limiting speed

Detailed parameters and installation dimensions:

Part Number	22214
Series	222series (222..)
Cage	Stamped steel cage
Speed ratings (oil) - n_G	6671 rpm
Seal	Open

Reference From	SKF 22214
Principal Dimensions Inside - d ϕ (mm)	70
Inside - d ϕ tolerance	-0.015 mm to 0
Principal Dimensions Outside - D Φ (mm)	125
Outside - D Φ tolerance	-0.018 mm to 0
Principal Dimensions Width - B (mm)	31
Width - B tolerance	-0.06 mm to 0
Rows NO.	2
Bore Type	Z = cylindrical bore
Principal Dimensions Inside - d ϕ (inch)	2.756
Principal Dimensions Outside - D Φ (inch)	4.921
Principal Dimensions Width - B (inch)	1.220
RIC	Normal
Load Direction	Combined
Bearing Mass - m	1.6 kg 3.527 lb
Permissible angular misalignment	1.5 degrees
Dynamic Radial Capacity - C _r	47748 lbf 212383 N
Static Radial Capacity - C _{0r}	51166 lbf 227586 N
Heat stabilization	392 °F (200 °C)
Temperature - T(min)	-30 °C
Temperature - T(max)	+200 °C
Dimension - d ₂	83 mm 3.268 inch
Units	Metric
Roller bearing type	Spherical
Dimension - D ₁	111 mm 4.370 inch
Bearing Type	Spherical roller bearings, double row
Manufacturer Part Code	22214
Ring material	GCr15SiMn
Dimension - b	6 mm 0.236 inch
Roller material	GCr15SiMn
Dimension - K	3 mm 0.118 inch
Dimension - r ₁ ,r ₂ (min.)	1.5 mm 0.059 inch

Web: <https://en.tradebearings.com/>

Email: admin@tradebearings.com