

PSM506050A51

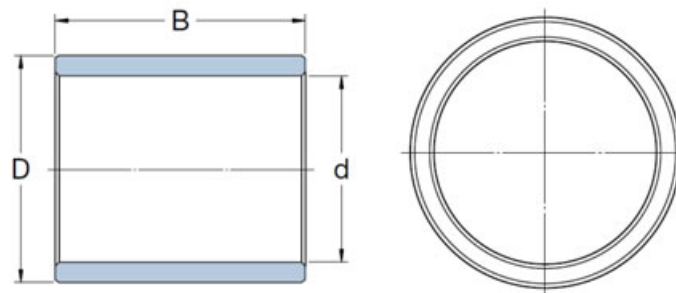

Technical sheet of PSM506050A51

Type :	Sleeve Bearing	
Model :	PSM506050A51	
Main demensions :	50 mm × 60 mm × 50 mm	Bore Dia × Outside Dia × Width Dia
M kg:	0.27	Mass
d mm:	50	inner ring diameter
D mm:	60	Outer ring diameter
B(T) mm:	50	Overall Width

Detailed parameters and installation dimensions:

Part Number: PSM506050A51

Technical description (A51): A51=(SINT A51) Sintered Bronze Bushing With A Porosity Volume Of 28% Impregnated With Mineral Oil.

The equivalent designations: 7316571791005

Bearing Type: Bushing

Size(metric): Inner dia. (d): 50 mm X Outer dia. (D): 60 mm X Width (B): 50 mm or Size: 50 mm * 60 mm * 50 mm

Original Equipment Manufacture(OEM NO.): PSM506050A51

Tradebearing(TBS): <https://en.tradebearings.com/>

Email: admin@tradebearings.com
 Whatsapp/Mob.: +86 15906428604