

6326M/C3

Deep groove ball bearings, Single row

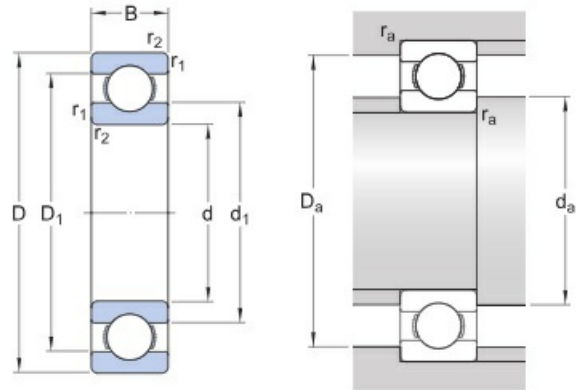

Technical sheet of 6326M/C3

What are the Benefits of choosing 6326M/C3 bearings?

- **Versatile Load Bearing:** Capable of simultaneously withstanding radial and bidirectional axial loads, suitable for high-speed and ultra-high-speed applications.
- **Low Friction and Long Life:** Optimized contact between the raceway and steel balls results in an extremely low coefficient of friction, minimal heat generation, and a long service life.
- **High Speed Capability:** Due to high operational precision, it allows for very high maximum speeds.
- **Low Maintenance Costs:** Can be designed with dust covers or sealing rings for lifetime lubrication, requiring no routine maintenance.
- **Rigid and Quiet Operation:** Provides a certain level of rotational stiffness while maintaining low operating noise and vibration levels.

Type :	Single row deep groove ball bearings	
Model :	6326M/C3	
Main demensions :	130 mm × 280 mm × 58 mm	Bore Dia × Outside Dia × Width Dia
M kg:	17.5	Mass
HS Code :	8482102000	Bearing customs code
d mm:	130	inner ring diameter
D mm:	280	Outer ring diameter
B(T) mm:	58	Overall Width

Cr kN:	228.554	Radial dynamic load rating
C_{0r} kN:	215.809	Radial static load rating
Grease r/min:	4993	Reference speed
Oil r/min:	4452	Limiting speed

Detailed parameters and installation dimensions:

Part Number	6326M/C3
Cage	M = Machined brass cage, ball centred
Rows NO.	One
Series	63..M
Principal Dimensions Inside - d ϕ (mm)	130
Principal Dimensions Outside - D Φ (mm)	280
Principal Dimensions Width - B (mm)	58
Minimum load coefficient - k _r	0.03
Calculation coefficient - f ₀	13.6
Dynamic Radial Capacity - C _r	228554 N 51378 lbf
Static Radial Capacity - C _{0r}	215809 N 48513 lbf
Ring Material	GCr15SiMn
Dimension - d ₁	177.6 mm 6.992 inch
Bore Type	Cylindrical bore
Seal	Open
Dimension - D ₁	231.5 mm 9.114 inch
Speed ratings (grease) - n _B	4993 r/min
Lubricant	No
Dimension Chamfer - r _{1,r2} (min.)	4 mm 0.157 inch
Fillet dimensions - r _a (max.)	3 mm 0.118 inch
Speed ratings (oil) - n _G	4452 r/min
Fatigue load limit - P _u	6273 N 1410 lbf
Internal clearance	C3
Outer ring feature	No
Principal Dimensions Inside - d ϕ (inch)	5.118
Principal Dimensions Outside - D Φ (inch)	11.024
Principal Dimensions Width - B (inch)	2.283
Heat stabilized	120 °C (250 °F)
Ball Material	GCr15SiMn
Bearing type	Deep groove ball bearings, Single row
Bearing Mass - m	17.5 kg 38.581 lb
Manufacturer Part Code	6326 M
Abutment dimensions - d _a (min.)	147 mm 5.787 inch
Tolerance class	PN
Abutment dimensions - D _a (max.)	263 mm 10.354 inch
Radial run-out	PN
Dimensional tolerances	PN

What are the applications of the 6326M/C3 bearing?

- **Motors/Electrical Appliances:** Used in motors and home appliances. Ensures smooth high-speed operation and low noise.
- **Automotive Industry:** Used in generators and gearboxes. Suitable for medium loads and offers high reliability.
- **General Machinery:** Used in pumps, fans, and speed reducers. Low friction, maintenance-free, and long service life.

Tradebearing(TBS): <https://en.tradebearings.com/>

Email: admin@tradebearings.com

Whatsapp/Mob.: +86 15906428604